

Focus Building, 17 Standish Street, Liverpool, Merseyside L3 2BD

£850 PCM

Welcome to the Focus Building, an elegant apartment located at 17 Standish Street in the vibrant city of Liverpool. This charming property offers a perfect blend of modern living and urban convenience, making it an ideal choice for individuals or couples seeking a stylish home in a bustling area.

The apartment features a well-appointed open plan kitchen / reception room, providing a welcoming space for relaxation and entertaining guests. The bedroom is designed for comfort, offering a peaceful retreat at the end of a busy day. The bathroom is fitted with contemporary fixtures, ensuring a pleasant experience for daily routines.

Situated in a prime location, residents will enjoy easy access to a variety of local amenities, including shops, restaurants, and public transport links. The lively atmosphere of Liverpool is right at your doorstep, with cultural attractions and recreational activities just a short distance away.

This apartment is perfect for those who appreciate the convenience of city living while enjoying the comfort of a well-designed home.

Deposit: £980
Council Tax Band: B



Hallway
 Cylinder Cupboard
 Open Plan Lounge Kitchen
 Bedroom 1
 Bathroom

Energy Efficiency Rating		
	Current	Potential
Very energy efficient - lower running costs		
(92 plus) A		
(81-91) B		
(69-80) C		
(55-68) D		
(39-54) E		
(21-38) F		
(1-20) G		
Not energy efficient - higher running costs		
	77	86
England & Wales	EU Directive 2002/91/EC	

Environmental Impact (CO ₂) Rating		
	Current	Potential
Very environmentally friendly - lower CO ₂ emissions		
(92 plus) A		
(81-91) B		
(69-80) C		
(55-68) D		
(39-54) E		
(21-38) F		
(1-20) G		
Not environmentally friendly - higher CO ₂ emissions		
England & Wales	EU Directive 2002/91/EC	

FOURTH FLOOR

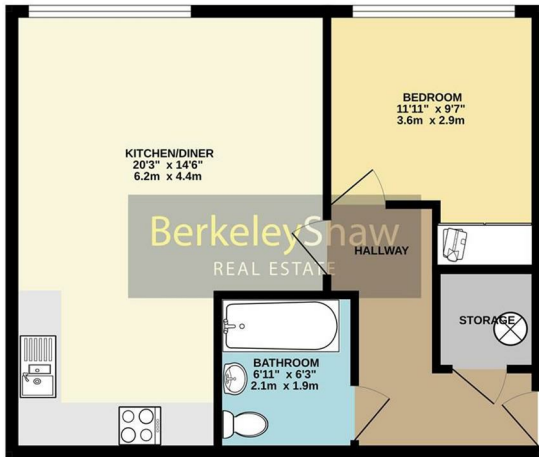

While every attempt has been made to ensure the accuracy of the floorplan contained here, measurements of floor, ceiling, walls and any other fixed and immovable and/or responsible fixtures for any other dimension or area statement. This plan is for illustrative purposes only and should be used as such by any prospective purchaser. The services, fixtures and appliances shown here have not been tested and no guarantee is given as to their condition or efficiency and no guarantee is given. Made with SketchUp 2020.



Berkeley Shaw Estate Agents Limited.
 Company No. 0784754

Berkeley Shaw Real Estate Limited.
 Company No. 05206927

